

FORGED STEEL WHEELS

20,000 ^{LBS} maximum capacity



Item Shown: 05201-20-12

FEATURES

Bearings: Roller, tapered, plain, teflon.

Temperature: Maximum to 800 degrees with proper bearings and lubrication.

Standard: All 1-1/2" and 2" wide wheels are supplied with 1/2" spanner standard.

BENEFITS

Forged steel wheels are hot forged from high carbon steel billets heated to 2,400 degrees Fahrenheit then repeatedly hit by high tonnage forging hammers. This process enhances the grain structure and increases the ductility and tensile strength (64,000 psi) of the wheel. The wheels are then precision machined flat with rounded edges to finished tolerances.

Forged steel wheels offer the greatest load capacity, impact strength and rollability of all caster wheels.

Wheel material codes: forged steel (20); heavy duty forged steel (21); ductile iron (12).

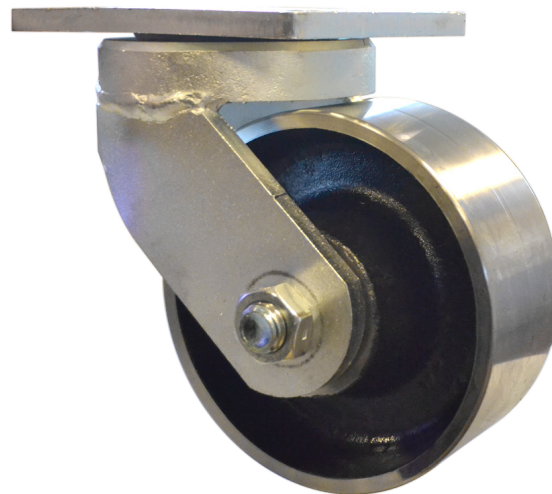

Forged steel wheels allow users to achieve a greater load capacity as well as being more resistant to heat.

WHEEL					PART NUMBER			
Dia.	Width	Capacity	Hub Length	Bore	Straight Roller	Precision Tapered	Less Bearing	Wt.
4	1.50	1,400	2 3/16	1 3/16			04100-20-19	3.25
4	1.50	1,400	2 3/16	3/4	04101-20-12			3.25
4	1.50	1,400	2 7/16	1/2		04109-20-08		3.25
5	1.75	1,500	2 3/16	1 3/16			05200-20-19	5.25
5	1.75	1,500	2 3/16	3/4	05201-20-12			5.25
5	1.75	1,800	2 7/16	1/2		05209-20-08		5.25
6	2.00	1,500	2 3/16	1 3/16			06200-20-19	6.25
6	2.00	1,500	2 3/16	3/4	06201-20-12			6.25
6	2.00	2,500	2 7/16	1/2		06209-20-08		6.25
6	2.50	4,000	3 1/4	1 15/16			06250-20-31	12.00
6	2.50	4,000	3 1/4	1 1/4	06251-20-20			12.00
6	2.50	4,000	3 1/4	1	06251-20-16			12.00
6	2.50	5,000	3 1/2	3/4	06259-20-12			12.00
6	2.50	5,000	3 1/2	1		06259-20-16		12.00
6	3.00	6,000	3 1/4	2 7/16			06300-20-39	20.00
6	3.00	6,000	3 1/4	1 1/4	06301-20-20			20.00
6	3.00	6,000	3 1/4	1 1/2	06301-20-24			20.00
6	3.00	10,000	3 1/2	1 1/4		06309-20-20		21.00
6	3.00	10,000	3 1/2	1		06309-20-16		21.00
6	3.00	17,000	3 1/4	3 1/8^			06308-21-50	22.00
6	3.00	17,000	3 1/2	1 1/4		06309-21-20		22.00
6	3.00	17,000	3 1/2	1 1/2		06309-21-24		22.00
8	2.50	4,000	3 1/4	1 15/16			08250-20-31	12.00
8	2.50	4,000	3 1/4	1	08251-20-16			12.00
8	2.50	4,000	3 1/4	1 1/4	08251-20-20			12.00
8	2.50	5,000	3 1/2	3/4		08259-20-12		12.00
8	3.00	4,500	3 1/4	1 15/16			08300-20-31	18.50
8	3.00	4,500	3 1/4	1	08301-20-16			18.50
8	3.00	4,500	3 1/4	1 1/4	08301-20-20			18.50
8	3.00	5,500	3 1/2	3/4		08309-20-12		18.50
8	3.00	5,500	3 1/2	1		08309-20-16		18.50
8	4.00	8,400	4 1/4	2 7/16			08400-20-39	37.00
8	4.00	8,400	4 1/4	1 1/4	08401-20-20			37.00
8	4.00	8,400	4 1/4	1 1/2	08401-20-24			37.00
8	4.00	10,000	4 1/2	1		08409-20-16		37.00
8	4.00	10,000	4 1/2	1 1/4		08409-20-20		37.00
8	4.00	20,000	4 1/4	3 1/8^			08408-21-50^	37.00
8	4.00	20,000	4 1/2	1 1/4		08409-21-20		37.00
8	4.00	20,000	4 1/2	1 1/2		08409-21-24		37.00



FORGED STEEL WHEELS 20,000 LBS

WHEEL					PART NUMBER			
Dia.	Width	Capacity	Hub Length	Bore	Straight Roller	Precision Tapered	Less Bearing	Wt.
10	3.00	5,000	3 1/4	1 15/16			<u>10300-20-31</u>	28.00
10	3.00	5,000	3 1/4	1	<u>10301-20-16</u>			28.00
10	3.00	5,000	3 1/4	1 1/4	<u>10301-20-20</u>			28.00
10	3.00	6,000	3 1/2	3/4		<u>10309-20-12</u>		28.00
10	3.00	6,000	3 1/2	1		<u>10309-20-16</u>		28.00
10	3.00	6,000	3 1/4	2 7/16			<u>10300-21-39</u>	28.00
10	3.00	6,000	3 1/4	1 1/4	<u>10301-21-20</u>			28.00
10	3.00	6,000	3 1/4	1 1/2	<u>10301-21-24</u>			28.00
10	3.00	6,500	3 1/2	1		<u>10309-21-16</u>		28.00
10	3.00	6,500	3 1/2	1 1/4		<u>10309-21-20</u>		28.00
10	4.00	8,400	4 1/4	2 7/16			<u>10400-20-39</u>	48.00
10	4.00	8,400	4 1/4	1 1/4	<u>10401-20-20</u>			48.00
10	4.00	8,400	4 1/4	1 1/2	<u>10401-20-24</u>			48.00
10	4.00	10,000	4 1/2	1		<u>10409-20-16</u>		48.00
10	4.00	10,000	4 1/2	1 1/4		<u>10409-20-20</u>		48.00
10	4.00	20,000	4 1/4	3 1/8 [^]			<u>10408-21-50</u>	48.00
10	4.00	20,000	4 1/2	1 1/4		<u>10409-21-20</u>		48.00
10	4.00	20,000	4 1/2	1 1/2		<u>10409-21-24</u>		48.00
12	4.00	7,500	4 1/4	2 7/16			<u>12400-12-39*</u>	53.00
12	4.00	7,500	4 1/4	1 1/4	<u>12401-12-20*</u>			53.00
12	4.00	7,500	4 1/4	1 1/2	<u>12401-12-24*</u>			53.00
12	4.00	7,500	4 1/2	1		<u>12409-12-16*</u>		53.00
12	4.00	7,500	4 1/2	1 1/4		<u>12409-12-20*</u>		53.00
12	5.00	10,000	5 1/4	1 1/4	<u>12501-12-20*</u>			98.00
12	5.00	10,000	5 1/4	1 1/2	<u>12401-12-24*</u>			98.00
12	5.00	10,000	5 1/2	1 1/4		<u>12509-12-20*</u>		98.00
12	5.00	10,000	5 1/2	1 1/2		<u>12509-12-24*</u>		98.00

[^] Dimensions for tapered bearing bore.

* These wheels are cast ductile iron.

All dimensions are in inches. All weights are in pounds.